



**DG M TT 2P 275 FM (952 115)**

- Prewired complete unit consisting of a base part and plug-in protection modules
- High discharge capacity due to heavy-duty zinc oxide varistors / spark gaps
- High reliability due to "Thermo Dynamic Control" SPD monitoring device



Figure without obligation

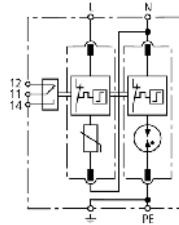

Basic circuit diagram DG M TT 2P 275 FM

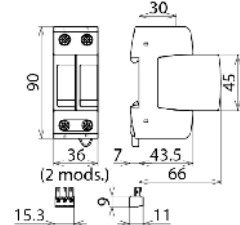

Dimension drawing DG M TT 2P 275 FM

Modular surge arrester for single-phase TT and TN systems ("1+1" circuit); with floating remote signalling contact.

Type	DG M TT 2P 275 FM
Part No.	952 115
SPD according to EN 61643-11 / IEC 61643-11	type 2 / class II
Nominal a.c. voltage ( $U_N$ )	230 V (50 / 60 Hz)
Max. continuous operating a.c. voltage [L-N] ( $U_C$ )	275 V (50 / 60 Hz)
Max. continuous operating a.c. voltage [N-PE] ( $U_C$ )	255 V (50 / 60 Hz)
Nominal discharge current (8/20 $\mu$ s) ( $I_n$ )	20 kA
Max. discharge current (8/20 $\mu$ s) ( $I_{max}$ )	40 kA
Lightning impulse current (10/350 $\mu$ s) [N-PE] ( $I_{imp}$ )	12 kA
Voltage protection level [L-N] ( $U_P$ )	$\leq 1.5$ kV
Voltage protection level [L-N] at 5 kA ( $U_P$ )	$\leq 1$ kV
Voltage protection level [N-PE] ( $U_P$ )	$\leq 1.5$ kV
Follow current extinguishing capability [N-PE] ( $I_h$ )	100 A <sub>rms</sub>
Response time [L-N] ( $t_A$ )	$\leq 25$ ns
Response time [N-PE] ( $t_A$ )	$\leq 100$ ns
Max. mains-side overcurrent protection	125 A gG
Short-circuit withstand capability for max. mains-side overcurrent protection ( $I_{SCCR}$ )	50 kA <sub>rms</sub>
Temporary overvoltage (TOV) [L-N] ( $U_T$ ) – Characteristic	335 V / 5 sec. – withstand
Temporary overvoltage (TOV) [L-N] ( $U_T$ ) – Characteristic	440 V / 120 min. – safe failure
Temporary overvoltage (TOV) [N-PE] ( $U_T$ ) – Characteristic	1200 V / 200 ms – withstand
Operating temperature range ( $T_U$ )	-40 °C ... +80 °C
Operating state / fault indication	green / red
Number of ports	1
Cross-sectional area (min.)	1.5 mm <sup>2</sup> solid / flexible
Cross-sectional area (max.)	35 mm <sup>2</sup> stranded / 25 mm <sup>2</sup> flexible
For mounting on	35 mm DIN rails acc. to EN 60715
Enclosure material	thermoplastic, red, UL 94 V-0
Place of installation	indoor installation
Degree of protection	IP 20
Capacity	2 module(s), DIN 43880
Approvals	KEMA, VDE, UL, VdS
Type of remote signalling contact	changeover contact
a.c. switching capacity	250 V / 0.5 A
d.c. switching capacity	250 V / 0.1 A; 125 V / 0.2 A; 75 V / 0.5 A
Cross-sectional area for remote signalling terminals	max. 1.5 mm <sup>2</sup> solid / flexible
Weight	228 g
Customs tariff number	85363030
GTIN	4013364108424
PU	1 pc(s)

We reserve the right to introduce changes in performance, configuration and technology, dimensions, weights and materials in the course of technical progress. The figures are shown without obligation.

2 Samantha Street, Strijdom Park, Randburg, Johannesburg, 2194  
 Tel: (+27) 11 886-7874 | Fax: (+27) 11 787 0178  
 sales@sinetech.co.za | www.sinetech.co.za

